

2019/01

933.000.800.00

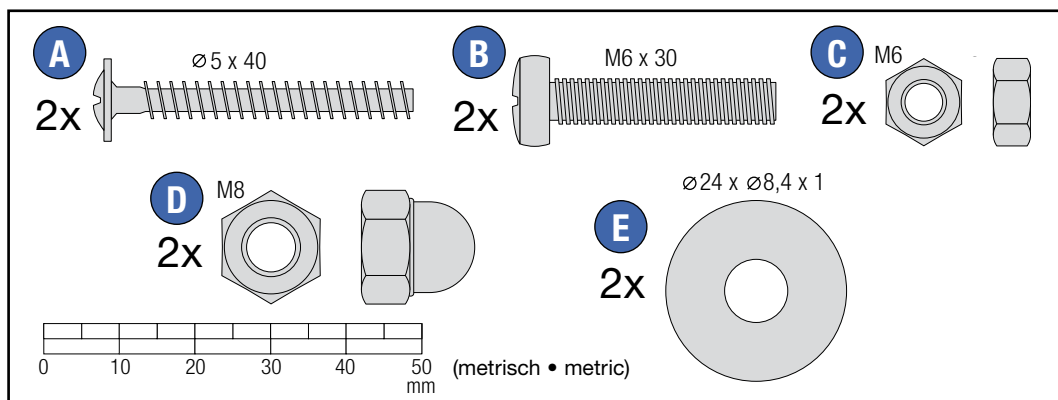

→ **			
● +10	● +26	● +47	
● +12	● +30	● +51	
● +13	● +37	● +54	
● +20	● +40	● +70	
● +22	● +41	● +75	
● +23	● +44	● +80	

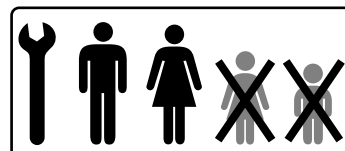
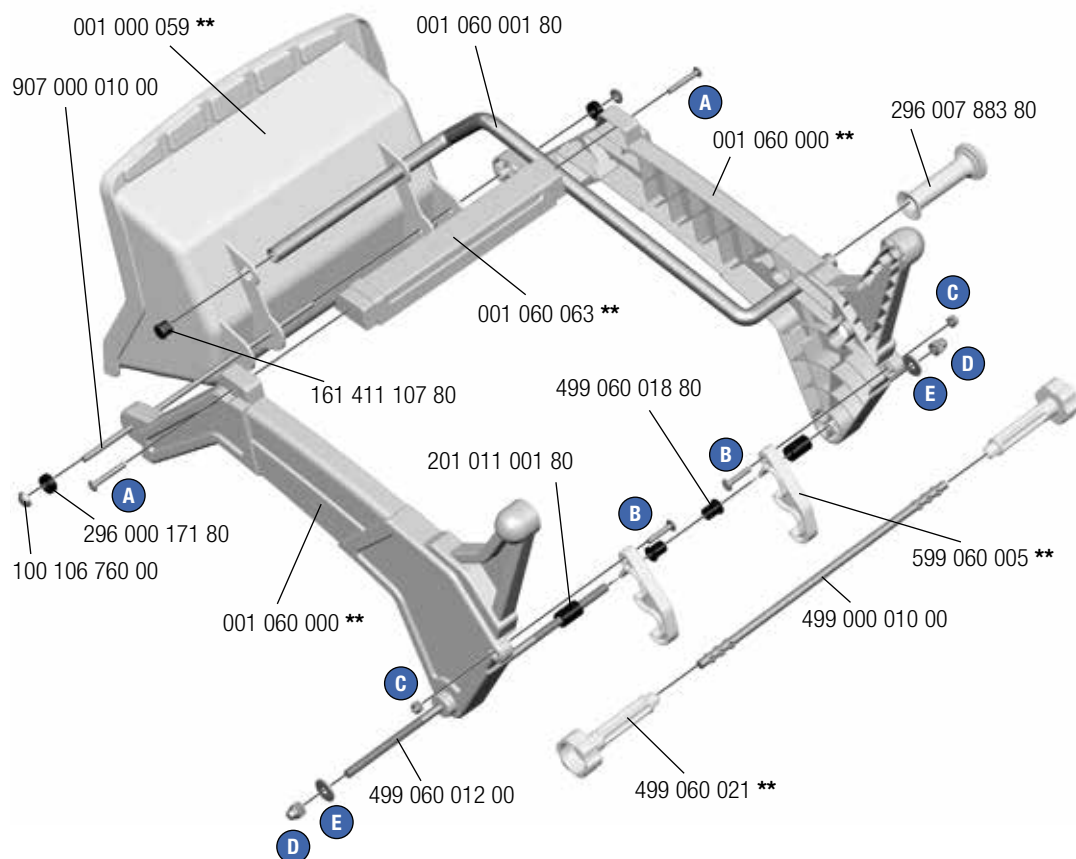

WARNING:

CHOKING HAZARD – Small parts.
Not for children under 3 years.

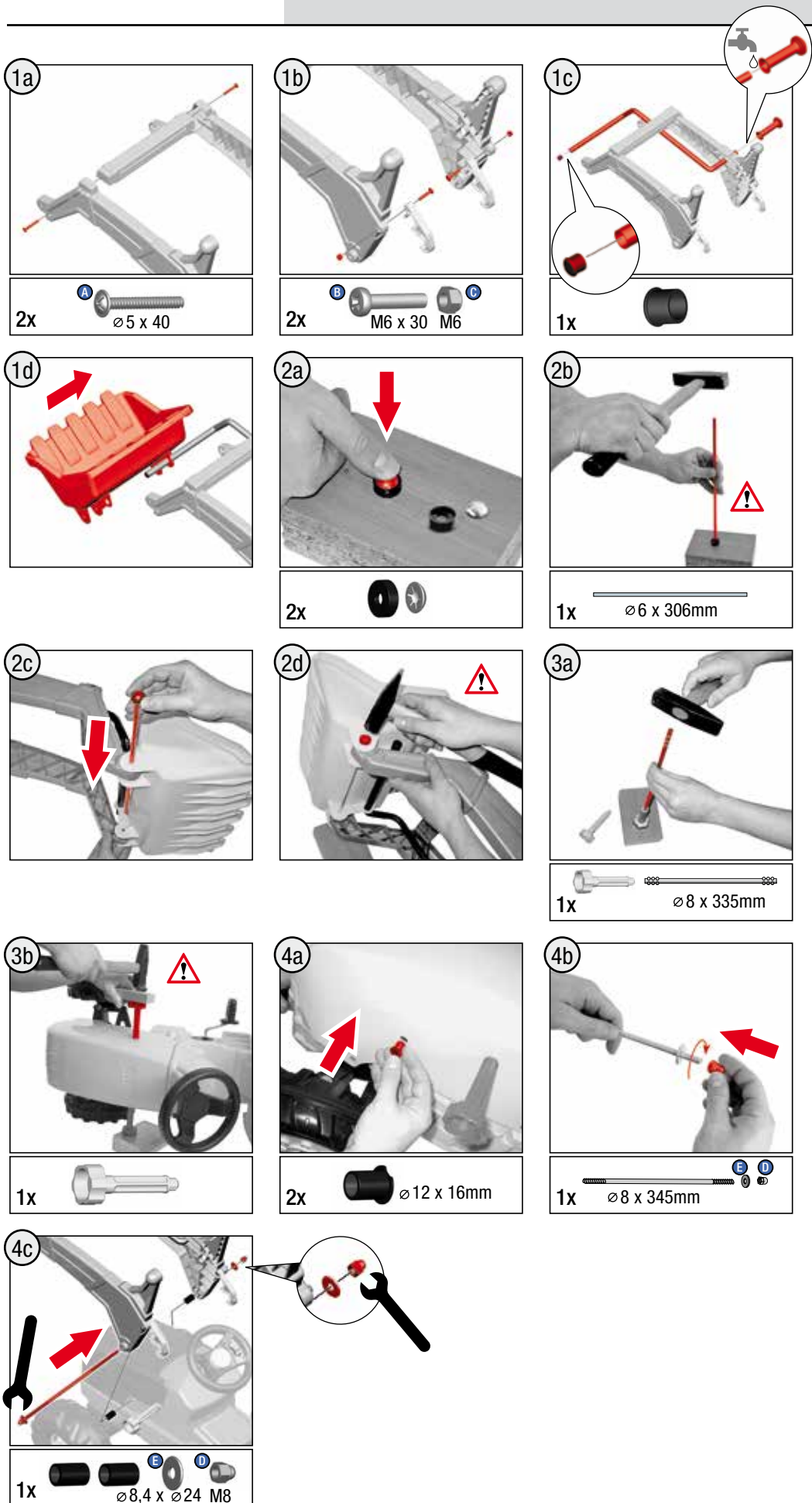

---NORTH & SOUTH AMERICA only---

180 days warranty

From the date of purchase +
guaranteed spare part service

The warranty does not cover damages
caused by improper use or neglect



WARNING

- **CHOKING HAZARD** - Small parts, Danger of being swallowed. Contains small parts in non assembled state. Must be assembled by adults.
- Toy is not suitable to carry children.
- If toy is defective stop using it, repairs may only be carried out by adults.
- Adult supervision required.
- Never use near steps, slopes, driveways, hills, roadways, alleys or swimming pool areas.
- Always wear shoes.
- Conforms to the requirements of ASTM Standard Consumer Safety Specification on Toy Safety, F 963.

Plattform / Platform

80 *** *, 81 *** *

2018/11

810.000.800.00

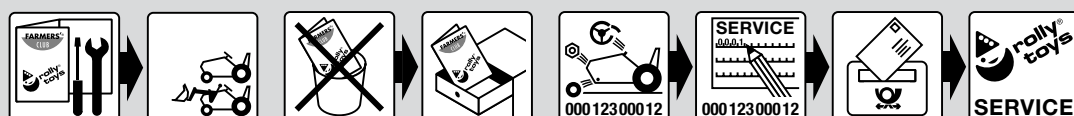
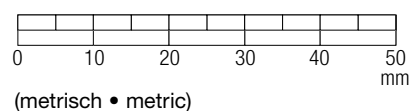
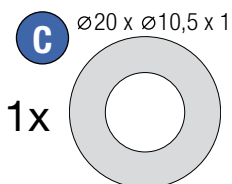
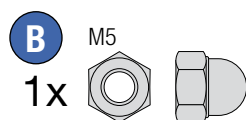
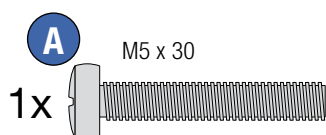
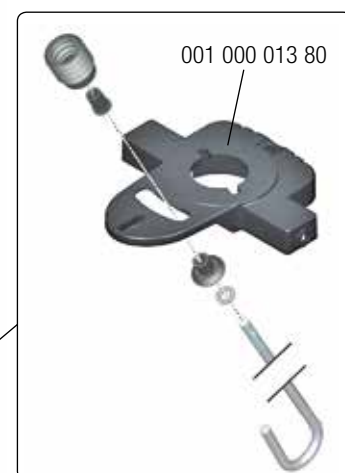
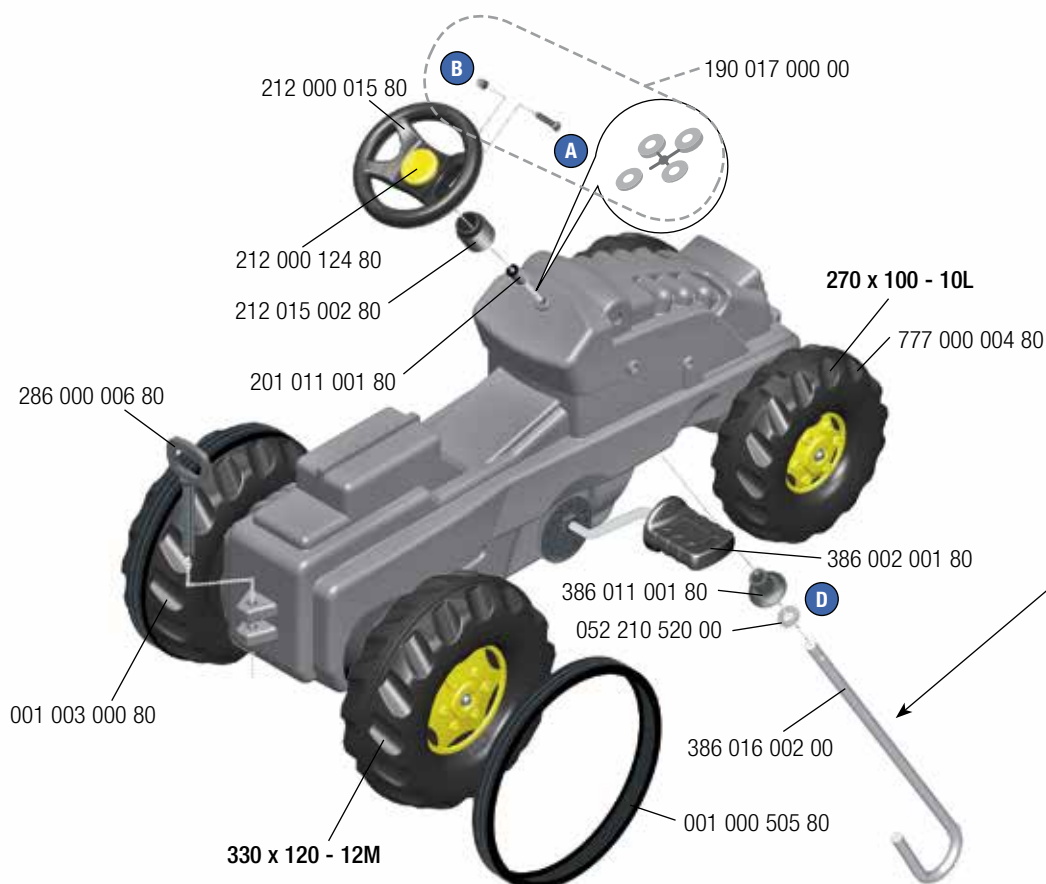

WARNING:

CHOKING HAZARD – Small parts.
Not for children under 3 years.



made
in
Germany

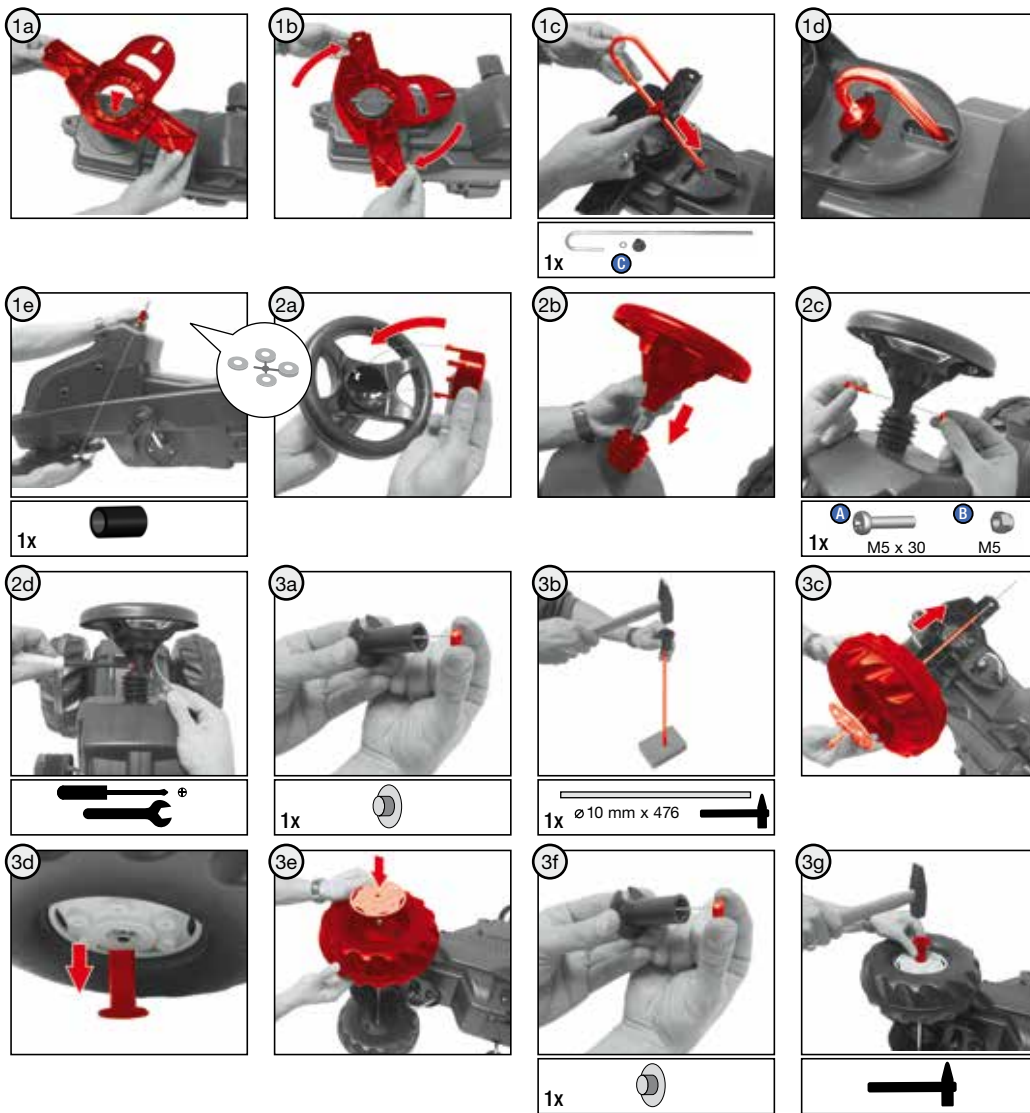

---NORTH & SOUTH AMERICA only---

180 days warranty

From the date of purchase +
guaranteed spare part service

The warranty does not cover damages
caused by improper use or neglect

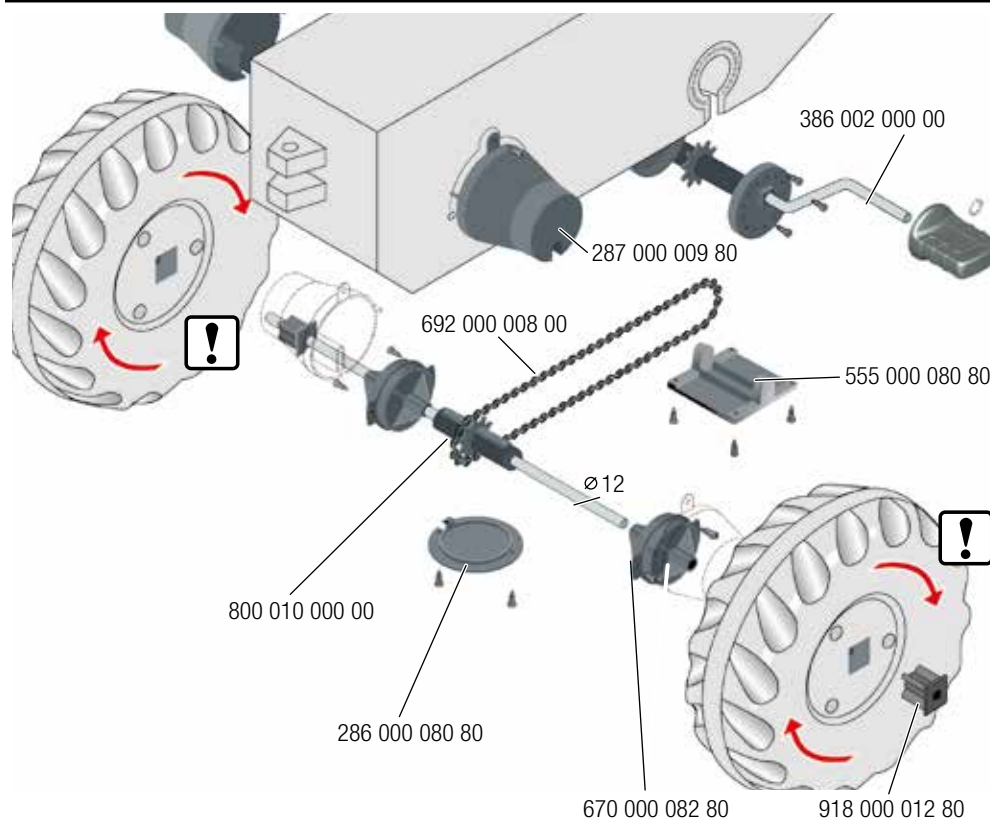

WARNING

- **CHOKING HAZARD** - Small parts, Danger of being swallowed. Contains small parts in non assembled state.
- Must be assembled by adults.
- If toy is defective stop using it, repairs may only be carried out by adults.
- Adult supervision required.
- Never use near steps, slopes, driveways, hills, roadways, alleys or swimming pool areas.
- Always wear shoes.
- Never allow more than one rider.
- The use of protective gear and safety helmet is highly recommended.
- Conforms to the requirements of ASTM Standard Consumer Safety Specification on Toy Safety, F 963.

Plattform / Platform

80 *** *, 81 *** *

2018/11

810.000.801.00

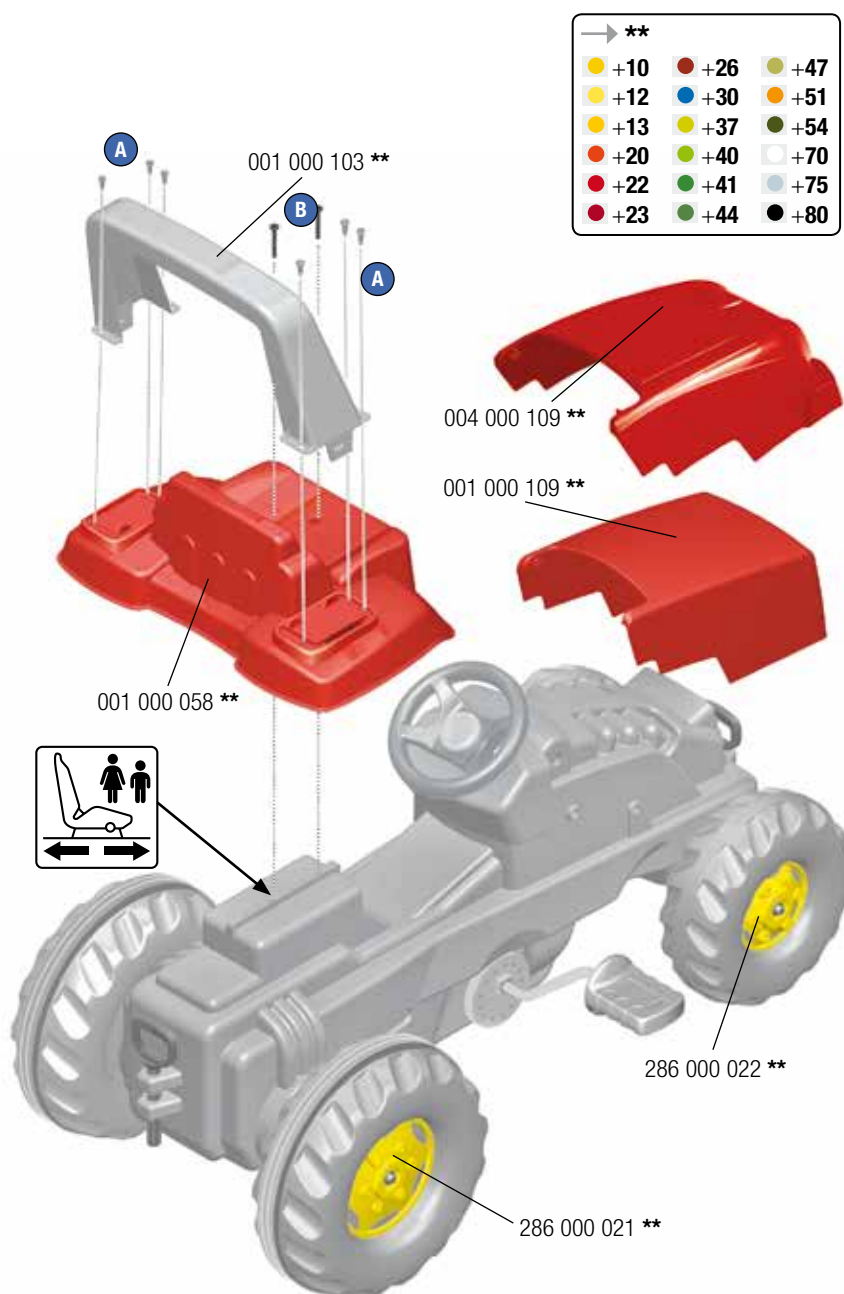
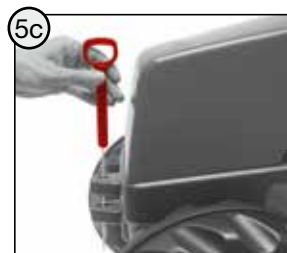
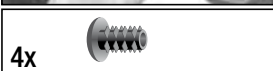
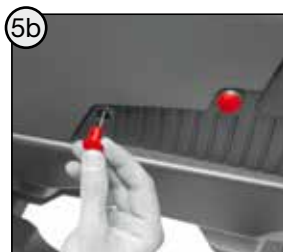
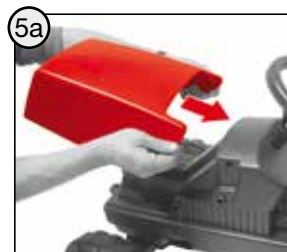
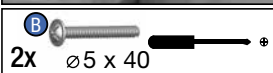
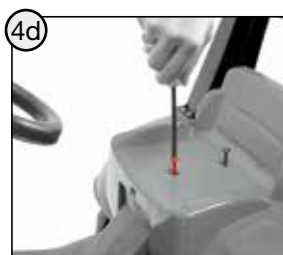
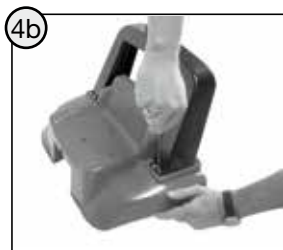
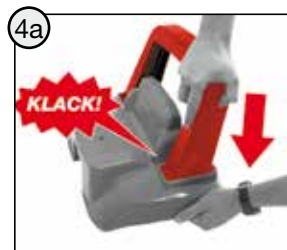



932.000.800.00

